

# Moorland Parish Link



July 2021

Church and Community Magazine of The Moorland Team

# The Ministry Team

<i>Team Rector</i> <b>Rt Revd Mark Rylands</b>	The Rectory, Copperwood Close Ashburton, TQ13 7JQ	01364 716309 mark.rylands@mmuk.net
<i>Team Vicar</i> <b>Revd Geoffrey Fenton</b>	The Vicarage, Widcombe-in-the-Moor, TQ13 7TF	01364 621334 geoffrey@moorlandteam.org.uk
<i>Mission and Family Development Worker</i> <b>Heidi Lewis</b>	Holne Vicarage, Holne, TQ13 7RT	07759578941 heidi@moorlandteam.org.uk
<i>Methodist Minister</i> <b>Revd Kevin Hooke</b>		01626 832369 hookekp@hotmail.com

## **Safeguarding:**

*If you have a concern about the safety of someone or the actions of someone working with children or vulnerable adults, please speak to someone:*

*Moorland Team Safeguarding Adviser - Judy Southcombe 01364 621520*

*Diocesan Safeguarding Team - [SafeguardingEnquiry@exeter.anglican.org](mailto:SafeguardingEnquiry@exeter.anglican.org)*

**Moorland Team Website:** [www.ashburtonandmoor.org.uk/](http://www.ashburtonandmoor.org.uk/)

## **Table of Contents**

The Ministry Team	2	St Gabriel, Postbridge	21
Safeguarding	2	Church Services for July 2021	24
The Parish Letter	3	Holy Communion Midweek & Home	25
Churchwardens	4	Dates for the Diary	25
Moorland Team Officers	4	St Pancras, Widcombe-in-the-Moor	27
Church News & Events	5	Dunstone & Poundsgate Chapels	39
St Mary the Virgin, Holne	11	Other Community News & Events	41
St Raphael, Huccaby	15	Rainfall	45
St John the Baptist, Leusdon	19	Final Word	47

## The Parish Letter

As a child, on a sunny July afternoon, I enjoyed nothing better than having a pot of Bubble-Blow mixture with the rather drippy plastic loop that was part of the lid, and blowing bubbles across the garden. The sun glinting on them in all the colours of the rainbow. The way they sailed up and away, over the shrubs and trees. Their sudden disappearance in an almost audible “pop”. If I ran, a great stream of bubbles would follow me like the tail of a comet. There was something magical about bubbles – until the pot was empty, or I knocked it over and it was all spilled – and then there were tears!

Well, during the pandemic, the word “bubble” has acquired a whole new meaning – groups of people who are allowed to mix together. Their purpose (to bring happiness) is still the same – a bubble is a delightful term to describe a small group bringing joy to each other’s lives, who brighten up a day by being in the same room.

During the pandemic, clearly the hardest thing has been losing a loved one to Covid. But the next hardest thing has been to be without friends and family around. It’s been a real trauma being separated from those we love, because our longing for companionship is a massive part of being human.

Before the pandemic we took so much for granted – like dropping in for a cup of tea, playing whist, going to a coffee morning, chatting on a bench. This all fell away, such that someone I was talking to recently became so lonely that getting a single letter through the post-box was the highpoint of the week – they had no other contact.

Thank goodness we’re coming out of Lockdown. Each stage brings more mood-enhancing – meeting outside, meeting inside in a bubble, going into shops, going to visit family, going into a pub, meeting anyone inside, going to outdoor events, and maybe soon going to every kind of indoor event and doing whatever we enjoy. Our bubbles are gradually expanding – from two to three, six, thirty, a hundred, any number and size we like!

But life has always been about bubbles, we just didn’t notice. Instead we used other words – family, extended family, club, society, office, team, group, and so on. Places where we enjoy being with other people. The safety, reassurance and fellowship of being with other people is incredibly important. Though it isn’t new! Jesus was part of

*Continued on page 5*

## Churchwardens

St Mary the Virgin, Holne with St Raphael, Huccaby			
Gillian Parker	Thimble Hall, Hexworthy, PL20 6SD	01364 631507	gillianp1992@gmail.com
Anthony Parker	as above	as above	anthonyfp999@gmail.com
St John the Baptist, Leusdon			
Geoff Bamsey	26 Old Manor Close, Holne Cross, TQ13 7JF	01364 652820	geoff.bamsey486@gmail.com
Patrick Simpson	Spitchwick Manor, Poundsgate, TQ13 7PB	01364 631209	admin@bennah.co.uk
St Gabriel, Postbridge			
Annie Smerdon	4A Oaktree Park, Sticklepath, EX20 2NB	01837 840201	gerald.postbridge@btconnect.com
Wendy Watson	Middle Merripit Farm, Postbridge, PL20 6TJ	01822 880215	wendy@merribridge.plus.com
St Pancras, Widecombe			
Michael Pascoe	Wooder Bungalow, Widecombe, TQ13 7TR	01364 621333	pascoewooder@yahoo.co.uk
St Andrews, Ashburton			
William West	Tawstock, Knowle Close, Ashburton TQ13 7RA	01364 652666	william1208west@me.com
Francis Parffrey	Hillcrest, Bowden Hill, Ashburton TQ13 7EA	01364 654067	francis.parffrey@gmail.com
St Mary the Virgin, Bickington			
Peter Warren	Rentor, Bickington	01626 821213	pw.rentor@gmail.com
St Peter, Buckland in the Moor			
Stephanie Palk	Halshanger Manor, Ashburton	01364 652430	stmp7@tiscali.co.uk

***For all editorial information - copy date, contact details etc. please see inside back cover.***

**BENEFICE OFFICE** - Cassie will be in the office on Tuesdays, Wednesdays and Fridays. She will be working remotely on Thursdays. Office hours are 9.00am - 3.00pm. Telephone **01364 654280 / 07445 240 133** or email: **admin@moorlandteam.org.uk**

**PARISH OFFICE** - Email: **parishoffice1@tiscali.co.uk**

## Moorland Team Officers

Treasurer	Francis Parffrey	Hillcrest, Bowden Hill, Ashburton TQ13 7EA	01364 654067	francis.parffrey@gmail.com
Secretary	Gillian Parker	Thimble Hall, Hexworthy, PL20 6SD	01364 631507	gillianp1992@gmail.com
Safeguarding Adviser	Judy Southcombe - 01364 621520		judysouthcombe@yahoo.co.uk	
Team Administrator	Cassie Long - 01364 654280		admin@moorlandteam.org.uk	

*(Continued from page 3)*

several bubbles – his family, his village, his twelve disciples. But also the next person he met – he would get alongside anyone, bubble with them, listen to them, encourage them and show them God’s love and forgiveness. It’s no surprise that his main message to everyone was to “love your neighbour” – to be a bubble with your neighbour?

Sadly there’s many people in our community without bubbles and in great need of companionship. The advert for Moorland Community Care in this magazine invites people to become part of a lonely person’s bubble – please consider it! It may feel a bit scary, but being in a new bubble is always likely to be of mutual benefit.

So, if Freedom Day comes this month, why not go and buy some Bubble-Blow and celebrate it by standing outside with someone and watching the bubbles sparkling with freedom in the sun? If you’re a bit embarrassed to be seen reverting to such childish behaviour, just find a quiet corner and enjoy them there. You may even catch a glimpse of me in the Vicarage Garden here in Widecombe blowing bubbles across the road!

*With every blessing*

*Geoffrey*

## **Moorland Parish Link Online**

This edition of the Moorland Parish Link (and previous editions) can be downloaded using the following links:

[https://www.widecombe-in-the-moor.com/parish\\_link/index.php](https://www.widecombe-in-the-moor.com/parish_link/index.php)

<https://ashburtonandmoor.org.uk/magazine-%26-notice-sheets>



Hello last men and women standing!

Suzy here from Moorland Community Care...

We are actively recruiting volunteers to do befriending calls and visits, gentle trips out, either by car or on foot, coffee morning and social group help, shopping assistance and gardening help.

We also need occasional help with moving house for vulnerable people.

If you're interested, my colleague Ami would so love to hear from you! Her number is 07538100461 and is on WhatsApp too.

Regular and occasional help so welcome and you become part of a friendly team!

## Churches Open

Our churches are open for services & private prayer. Opening times vary:

St Andrew's, Ashburton	Daily, 10.00am-4.00pm
St Mary the Virgin, Holne	Daily, 10.00am-4:30pm
St Raphael's, Huccaby	Daily, 9:30am-5:30pm
St Peter's, Buckland-in-the-Moor	Daily
St Mary the Virgin, Bickington	By appointment – 01626 821213
St Pancras, Widcombe	Daily 9.00am-5.00pm
St John the Baptist, Leusdon	Daily 9.00am-5.00pm
St Gabriel, Postbridge	Daily

Please check the website <https://ashburtonandmoor.org.uk/> and Facebook pages, **The Ashburton and Moorland Team** <https://www.facebook.com/moorlandteam> and **Ashburton All Age Church** <https://www.facebook.com/Ashburtonallage>, for the latest updates.

## From the Registers

Funeral    Holne    21 June 2021    Raymond William Codd

## An hour of quiet reflection at Postbridge Church

The monthly services that will return to the church one day can be found on:

<https://www.moorlandteam.org.uk/p.htm>

They can be used at any time, in particular if you are feeling you need a time of quiet in these challenging days.

*Geoffrey*

More information from Revd Geoffrey Fenton, Widcombe Vicarage, 01364 621334

**M T P ... as easy as 1 2 3**

**Installation . Service . Maintenance**

**For all your plumbing & heating requirements**

- ALL PLUMBING WORK UNDERTAKEN INC. PRIVATE WATER SUPPLIES – FITRATION & PH CORRECTION.
- OIL & SOLID FUEL CENTRAL HEATING INSTALLATIONS.
- REPLACEMENT OIL TANK INSTALLATIONS INC. CONSTRUCTION OF TANK BASES.
- NEW BATHROOM REFURBISHMENTS – FULL INSTALLATION PACKAGE TO INC. WETROOMS & UNDERFLOOR HEATING.
- OIL BOILER SERVICING / BREAKDOWN REPAIRS INC. AGA, RAYBURN, HERTIAGE & STANLEY.

**M T P Services LTD**

Contact Sam or Martin on 01822 880318

Email: [mtpservicesltd@live.co.uk](mailto:mtpservicesltd@live.co.uk)

**ANTON COAKER ENGLISH TIMBER LTD**

**Oak Beams or whole oak frames, Douglas Fir, Ash, Chestnut, Sycamore etc**

Green oak etc cut to order, air-dried stock in various timbers, kiln dried to order

**ALL ENGLISH TIMBER**



Logs also supplied, either ready cut or skinny offcuts

**SHERBERTON BEEF**

Meat from **OUR OWN ANIMALS** sold direct to you, fresh or frozen

**Sherberton Farm, Hexworthy**

Tel. no. 01364 631276 or email [wood@anton-coaker.co.uk](mailto:wood@anton-coaker.co.uk)

**bumblebee** 

garden services

for dartmoor & beyond

andy tarry

[andy@bumblebee.garden](mailto:andy@bumblebee.garden)

01364 621386 07775 947823

**Some things to do in July ...**

- Summer flowering Clematis needs liquid tomato feed
- Save water (yes, I know!)
- Mulch borders to retain moisture
- Check pond water level & clean
- Deadhead roses & bedding plants
- Cut back faded flowers
- Weed & water + harvest veg & stone fruit
- **Healthy, happy holidays! Andy**



## Prayers from Messy Church JULY 2021



As Messy Church reopened out of doors, the first time for over a year, there was much to do. The theme was “Thank you God” and there were flags and bunting to be painted, along with pebbles, an obstacle course, and other games to play outside.

There was a quieter time too, inside the church, when children were invited to write three “teaspoon prayers” that’s tsp --- Thanks, Sorry and Praise. Here are just a few of them (spellings tidied up).

Thanks for my guinea pigs and the little squeaks they do.

Thank you for the world.

Thank you for my lovely family.

Thank you for my friends.

Thank you for a lovely sunny swim.

Thank you for having plenty of food.

Thank you for being our Lord, Saviour, and friend.

Thank you for my birthday presents.

Sorry I’m a bit grumpy

Sorry I’m shouty

Sorry for shoving

Sorry I smashed a glass

Sorry for blaming J---

Sorry for chasing A--- with a bamboo stick

Sorry I’m only a little bit sorry for punching my sister

Sorry for not listening or doing what I’m told

Sorry for doing sins

Sorry for being a bad sister

Praise You that every day is a happy day

I praise God for everything He made

Praise God for the sunlight and all the weather

Praise be to God for P-----

Praise God that He made us

Praise God for wonderful days

Praise God for all the people who used to be alive and are now in heaven.

The simple words inspire me. Thank you, Barbara for writing this July article. As the bunting on the rails says Thank you God and Thank you Ashburton for helping us get through Covid. **July 10<sup>th</sup> Saturday is the next Messy Church in the Church and Church Garden all are welcome.** Jane

# Ashburton Baby Group

We are back to meeting in person every Wednesday morning from 10 to 11.30 am in St Andrew's Church Hall.

We have 10 lovely mums who have been meeting and going for walks together. We would love to welcome dads and babies as well. Please come and join in.

We also have an active "WhatsApp group" where ideas and first steps are shared.

See you next Wednesday morning in St Andrew's Church Hall at 10 am.

Contact Jane on 07850 974 286 or email [jashnton@globalnet.co.uk](mailto:jashnton@globalnet.co.uk) and I will put you on the WhatsApp group.



## Scoriton Village Hall

Situated on the edge of the village and available to hire at reasonable rates.

The hall is flexible in its use, with a main hall and large well fitted kitchen, for parties, meetings and sports eg badminton.

Full disabled facilities, including access, toilets and a hearing loop.

### Hall Hiring Tariff 2020

	Hourly	Day/Weekend
Hall hire	£12	£95 9am - 6pm
Party rate		£120 midday to midday
Weekend rate		£350 from midday Friday to 6pm Sunday

For more information or to book email [scoritonvillagehall@gmail.com](mailto:scoritonvillagehall@gmail.com)

For more details please see our website : <http://scoritonvillagehall.org/>

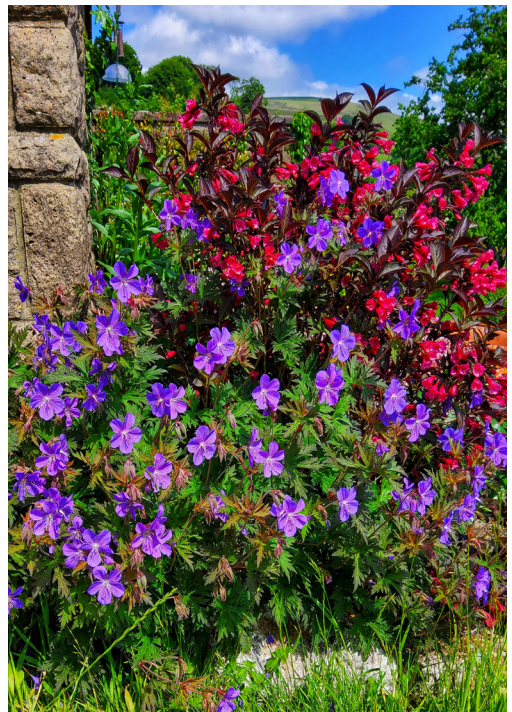



# St Mary the Virgin, Holne

For contact information, ministers and church officers see front of the Link

**Church Services - see Page 24 for details**

Date	Time	Service
4th July	-	
11th July	18:00	Holy Communion
18th July	09:00	Holy Communion at Huccaby
25th July	17:00	Evening Worship

## HOLNE VILLAGE HALL

1. At a meeting of the hall committee on May 19th, it was decided to continue the closure of the hall for the time being. The situation will be reviewed at the next meeting on June 22nd.

When it is possible to reopen the hall, a further notice will be placed in The Link.

2. As in 2020, the Plant Sale in the hall is cancelled for this year. However, donated plants will be for sale outside the hall [honesty box in place], and at Hilltop, Holne, by kind arrangement .

Any donations of plants are very welcome. [please ring Peter Bellamy 631323]. All proceeds to the hall.

Peter Bellamy. [Joint Chairman HVHMC].



# **County Cleansing** LIMITED

Septic Tanks - Sewage Systems - Cesspits

## **Septic Tanks Emptied**

Competitive Rates

01364 653900 or 07976 561906

Professional Reliable Clean Service

Specialty Adapted Vehicle for the Devon Lanes

24/7 Emergency Call out

**Contact Simon Fisher**

8 Fairfield Road, Kingskerswell, Newton Abbot, TQ12 5HQ  
countycleansing@btinternet.com

# **STEVE HUTCHINSON**

## **CARPENTER AND GENERAL BUILDER**

Tel. 01822 259344

Mob. 07737 765574



*Extensions      Alterations*

*Refurbishments*

*Fibreglass Flat Roofs*

*Carpentry*



# **K DECORATING**

INTERIOR AND EXTERIOR

## **PAINTER & DECORATOR**

FREE QUOTES    REFERENCES AVAILABLE

*Kevin Teague    Denbury*

Tel: 07810 262744 or 01803 813685



## **Moor logs**

[www.moorlogs.co.uk](http://www.moorlogs.co.uk)



## **logs for sale**

LOADS START FROM £80 FOR 1.5M

CALL TOM OR RACHEL ARROWSMITH-BROWN

MOBILE 07784 146037  
HOME 01822 880005



## **Moor Mobile Foot Clinic**

*Treatments in the comfort of your own home*

Nail Trimming (Including Diabetic Feet)	Dry Skin
Corns	Fungal and Thickened Nails
Callus	Ingrown Toenails
	Athletes Foot

**Rachel Arrowsmith-Brown**

S.A.C Dip FHPT/S.A.C Dip FHPP

01822 880005 or 07786930718

# **Mole Problems?**



For an efficient, humane  
**Mole Catching Service**  
in your area, that really works....!

Competitive prices.

Call Mick

Tel 01647 221357

Email [mickc911@gmail.com](mailto:mickc911@gmail.com)

## Holne Village Hall

Situated in the middle of the village, near Church, shop and Inn, available to hire at reasonable rates.

Medium sized hall with separate well equipped kitchen. Sufficient chairs and tables for any event.

Car parking adjacent to the Hall.

**Rates (per hour) £8 (£5 for locals)**

**For more information or to book:**

please ring Nicky Bellamy  
on 01364 631323

or email [holnevillagehall@gmail.com](mailto:holnevillagehall@gmail.com)

## HOLNE VILLAGE HALL SOUP & CHEESE LUNCH

**Lunches are cancelled  
until further notice**

## Whist Drives

are held in Holne Village Hall  
**All Whist Drives are cancelled until  
further notice.**



## Holne Second-Hand Books



Hill Top, Butts Cross, Holne

If you have any books, CDs, DVDs and jigsaws you can donate - please leave in the porch or garage at Hilltop.

Don't forget that you can buy books at any time. Open most days and weekends

**Mike and Gill Cuniam (01364 631152)**

Supporting Devon Air Ambulance and Holne Community projects.

## Holne Garden Group

We have been thinking hard about the Garden Club and our much missed outings. It may be a long time before we can go out by coach again, but how about half day outings, by car, to nearby places where we can walk in beautiful surroundings and chat with our friends from a safe distance? We are getting together a short list, something to cheer the long dark days of winter. Please email Judy to add your suggestions.



If you are interested, get in touch, or we will contact you all. In the meantime, very best wishes to all.

Gill Gray [gill@priddons.co.uk](mailto:gill@priddons.co.uk) 01364 631111 and

Judy Le Marchant [judylemarchant@btinternet.com](mailto:judylemarchant@btinternet.com) 01364 644099.

## Geoff Partridge NCH (Arb)

*For all your Arboriculture work*



### **Other services include**

- *Hedge Laying & other rural skills*
- *Wood chipper available*
- *Quad bike with sprayer - ideal for pony paddocks & small fields*
- *Advice & quotations given*

**Tel: 01364 621468**

**Mob: 07759 774394**

**email: gm.partridge68@gmail.com**

Over 35 years' experience in the industry  
5 Million Public Liability Insurance

**hmad|architects**

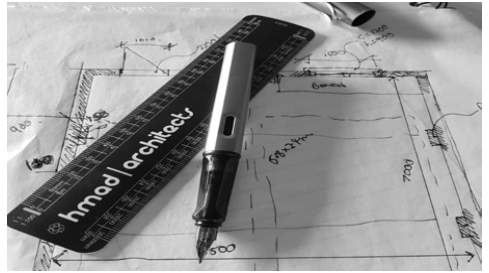

- Experienced, friendly and local RIBA chartered architecture practice based in Exeter.
- Specialising in the adaptation of listed buildings, residential extensions, renovations and low energy new builds.
- For a FREE consultation with hmad|architects please contact Luke McAdam:

**01392 459777 - MAIL@HMA.D.CO.UK  
WWW.HMA.D.CO.UK**

## **Glass, Locks and Security**

**Ashburton**

**Glass & Locks.co.uk**

- *Single, Double & Secondary Glazing*
- *Box Sash & Velux Window Repairs*
- *U.P.V.C. Repairs*
- *Locks, Hinges & Handle Repairs*
- *Emergency 24hr Locksmith & Boarding Service*

**A friendly, prompt and efficient service**

**Please contact Scott for further information or a free estimate**

**Telephone: 01364 631572**

**Mobile: 07786 355682**

# **Morris Bros. Funeral Directors**

Established in 1870

Your local independent Funeral Director is owned & run by the fifth generation of the Morris Family, Simon & Lucie Luke. We provide a qualified, professional & sensitive service to the people of Tavistock & surrounding areas. Simon & Lucie live on site at The Old Bedford Foundry providing you with a very personal service regardless of the time of day or night. Call for a 24 hour service on

**01822 612023**

**The Old Bedford Foundry  
Lakeside, Tavistock PL19 0AZ**

*Golden Charter Pre Paid Funeral Plans available*

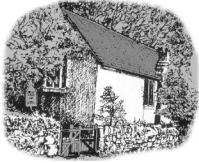

# St Raphael, Huccaby

For contact information, ministers and church officers see front of the Link

Church Services - see Page 24 for details

St.Raphael, Huccaby is open **daily between 9.30am and 5.30pm**



Coronavirus  
low on funds  
are you waiting  
for your  
Universal Credit?  
always looked  
after myself

no food  
hate forms  
lost job  
feel ashamed  
never asked  
for charity

don't know  
where your  
next meal is  
coming from?  
anxious  
never asked  
anyone for help

ASHBURTON-LOCKDOWN-LARDER-FREE-NO FORMS-CONFIDENTIAL-DELIVERED  
07902-390-558



## Sam Hall's Professional Tree Care

Hexworthy, South Devon  
Home: 01364 631405 Mobile: 07553 262329

[samhallsptc@hotmail.com](mailto:samhallsptc@hotmail.com)

[www.samhallstrecare.co.uk](http://www.samhallstrecare.co.uk)



- All aspects of Tree Surgery carried out
- Hedgetrimming and shaping
- Site Clearance work
- TPO/Conservation applications carried out
- Hardwood log supplies
- Over 10 years experience
- Fully insured with public liability up to £5 million.
- Free no obligation quote

Qualified \* Experienced \* Insured

Landscaping  
Groundworks  
Fencing

Log/Kindling Nets For Sale  
Call Tom on 07565503380

### Pottery Classes with Kate Lyons-Miller

I have recently been able to re-start my pottery classes at Holwell Studio, Widecombe in the Moor. Very small groups of 2/3, masks are worn and we do all we can to be Covid aware.

The classes are informal and friendly, handbuilding, but a kick wheel is available. Suitable for all ages and abilities, wheelchair friendly, except perhaps for access to the compost loo. I encourage experimentation, the only limits are the kiln sizes.

The sessions run on **Thursday, Friday and Saturdays, 10-12.30, or 2.00-5.00, and cost £20.00**, which includes first firing and basic materials, and of course, tea/coffee and biscuits, potters essentials. There is more information on my website, [www.katelyonsmiller.com](http://www.katelyonsmiller.com)

I'm very happy to say that I have just been selected as a member of The Devon Guild of Craftsmen at Bovey Tracey.

### Chiropractor? Back and Neck Pain?

Please call 01626 353334 or email [info@sykesverweycentre.co.uk](mailto:info@sykesverweycentre.co.uk)

- Established in 1963
- Over 55 years of helping people with spine, muscle, and joint problems.
- We are the oldest Chiropractic clinic in the South West
- Successfully treated thousands of patients.
- Our Director and Sports Chiropractor Freddie Powell was the 1<sup>st</sup> team Chiropractor at premiership football club Crystal Palace FC.

Located at 5 Brunel Buildings, Newton Abbot, TQ12 4PB







# St John the Baptist, Leusdon

For contact information, ministers and church officers see front of the Link

**Church Services - see Page 24 for details**

Date	Time	Service
4th July	16:00	Pet Service
11th July	12:00	Parish Communion
18th July	12:00	Parish Communion
25th July	12:00	Parish Communion

## Leusdon Church - Information and Support

Leusdon Church is open all day, every day. You are welcome to visit at any time – an opportunity to sit quietly, say a prayer and enjoy our beautiful building.

*Please wear a face-covering when inside the church, and be sure to use the hand-sanitiser when you enter and when you leave.*

We are holding services in the church every Sunday (as shown above). If you are not able to attend, why not download the latest service and use it at home? You can find it here:

<https://www.moorlandteam.org.uk/L>

Do give me a call if you'd like a chat.

Revd Geoffrey Fenton (Team Vicar) 01364 621334 [geoffrey@moorlandteam.org.uk](mailto:geoffrey@moorlandteam.org.uk)

## Leusdon Memorial Hall

As reported last month the Hall will open fully on 1st August 2021, (although some events will be allowed before this where we can enforce strict guidelines and they are of importance to the community).

Our first event will be the AGM which will take place on Wednesday 4th August 2021 at 7.30 pm. We would like any one with an interest in the Hall to come to the

*Continued on page 19*

Leusdon

# Sales Service Rentals

www.jsearle.co.uk

**Appliance Repairs  
Washing Machine, Tumble Dryers  
Dishwashers, Refrigeration  
All Manufactures**

J. Searle  
and son

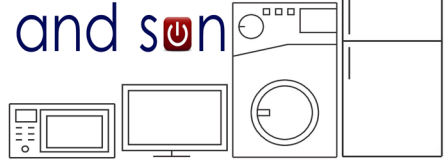

**All your Electrical needs in one place.**

**Large showrooms for all Appliances from TV's to Washing Machines,  
TumbleDryers, Cookers and Fridge Freezers. Your Local Euronics Centre  
Fast same day/next day FREE DELIVERY**

**Rental Centre:**

**Why buy when you can rent. Low monthly payments,  
no service worries, keep up to date with upgrades .  
Rentals subject to status.**



**43 FORE STREET BUCKFASTLIGH TQ11 0AA 01364 643242**



## Scott Build

Building & Maintenance

- Brick & Block Work
- Stone Work
- Driveways
- Drainage
- Alterations
- Extensions
- Fencing
- Refurbishments
- Slab Laying
- Ground Work
- Structural Work
- Garage Conversions
- Plastering & Rendering

FREE NO OBLIGATION QUOTES AND  
OVER 20 YEARS EXPERIENCE, FULLY INSURED.

OPERATING THROUGHOUT SOUTH HAMS,  
TORBAY & TEIGNBRIDGE AREAS.  
NO JOB TOO SMALL!

**CALL MARLDON: 01803 554931**  
**MOBILE: 07568 141127**

Scott Build • City & Guilds Approved • Fully Insured  
07568 141127 • 01803 554931 • Scottlount@gmail.com

## Ashburton Chimney Sweep

- \* Open fires
- \* Woodburning & multifuel stoves
- \* Nests removed
- \* Cowls fitted



**Available for Weddings**

*Very clean      Experienced  
Reasonable rates  
Satisfaction Guaranteed*

**For your free quote, please call**

**Tel: 01364 653440  
or 07791 737161**



(Continued from page 17)

meeting so as to be as representative as possible .

On Saturday 14th August we shall be holding a Dog Show and Table Top Sale, The Dog show will start at 2.00 pm, there will many different classes and rosettes to be won as well as a trophy for best in show. It will be followed by a fancy dress class. There will be refreshments available. I will give a further update in the August edition of the Parish Link. For those of you who would like more details before then please contact Amanda on 01364 631432 or email [leusdonmemorialhall@yahoo.com](mailto:leusdonmemorialhall@yahoo.com)

It is planned that the first coffee morning will be on Wednesday 1st September 10.00-12.00, it will follow the usual pattern with a few minor alterations, one of these being the hiring out of four tables per month at £5.00 each for anyone to sell anything they wish (within reason). One of these will be reserved for bric-a-brac. In addition we hope to set up a book and jigsaw swapping facility with a 10p administration charge via an honesty box. The coffee/tea, cakes and the raffle will continue.

Should you wish to book the Hall it will be available for hire from 1st August at £10.00 per hour by contacting our booking secretary:

Amanda Routley on 01364 631432  
Email: [leusdonmemorialhall@yahoo.com](mailto:leusdonmemorialhall@yahoo.com)

In the meantime, if anyone would like to discuss any aspect of the Hall please contact myself or any committee member.

My contact details are:  
John Southcombe Email: [johnsouthcombe@hotmail.com](mailto:johnsouthcombe@hotmail.com)

We look forward to getting back to normal as soon as conditions allow.

Kind regards

John Southcombe  
for Leusdon Memorial Hall. Charity no.300887

- General plumbing & heating
- Bathroom installations
- LPG and natural gas
- Free quotations
- Boiler installation & replacements
- Boiler servicing and breakdowns
- 24/7 emergency breakdowns



## CC PLUMBING AND HEATING SERVICES

Contact: 07521 972332

Email: [c.plumbingandheating@outlook.com](mailto:c.plumbingandheating@outlook.com)



## Log Splitting Services and Domestic Fencing



Self contained log splitting service  
quick and efficient.



Domestic fencing supplied and erected.

Please call Joe on 07899827352 or 01364 643467

## tristan denman

**ELECTRICAL CONTRACTOR**

Based on Dartmoor!

For more information on all our services or  
free estimates please call us on

T: 01647 441551 or M: 07966 024292

E: [info@tdenmanelectrical.co.uk](mailto:info@tdenmanelectrical.co.uk)

[www.tdenmanelectrical.co.uk](http://www.tdenmanelectrical.co.uk)



- Domestic, Industrial, Commercial & Agricultural
- Fault Finding, Free Advice, Visual Inspections & Reports
- Electric Safety Inspection Reports
- Portable Appliance Testing



## Rochelles Curtains and Blinds EST 1989

(now based on Dartmoor, in the South Hams & Exeter)

- Custom made curtains and blinds
- Free measuring & consultation service
- Wide selection of fabrics to choose from
- We also make with your own fabrics
- In house making service
- Tracks and poles
- All types of blinds
- 25+ years experience
- Alterations
- Fitting service

Tel: 01626 270076 Mobile: 07525 618286

email address: [phil-kendall@hotmail.co.uk](mailto:phil-kendall@hotmail.co.uk)

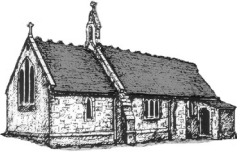

# St Gabriel, Postbridge

For contact information, ministers and church officers see front of the Link

**Church Services - see Page 24 for details**

Date	Time	Service
4th July	-	
11th July	09:00	Holy Communion
18th July	-	
25th July	18:00	Evening Prayer

## Postbridge Church - Information and Support

Postbridge Church is open all day, every day. You are welcome to visit at any time – an opportunity to light a candle, say a prayer and enjoy our beautiful building.

*Please wear a face-covering when inside the church, and be sure to use the hand-sanitiser when you enter and when you leave.*

We are holding services in the church on some Sundays (as shown above). If you are not able to attend, why not download the latest service and use it at home? You can find it here:

<https://www.moorlandteam.org.uk/p>

Do give me a call if you'd like a chat.

Revd Geoffrey Fenton (Team Vicar) 01364 621334 [geoffrey@moorlandteam.org.uk](mailto:geoffrey@moorlandteam.org.uk)

## POSTBRIDGE VILLAGE HALL

Available  
for Hire



*The Old Clapper Bridge, Postbridge*

Meetings  
Parties

*Special rate for Postbridge Residents*  
**Please call Jackie Gee 01822 880224**

# Clear Decorators

interior & exterior decorating

**07527 306012**

e: [cleardecorators@gmail.com](mailto:cleardecorators@gmail.com)  
[cleardecorators.co.uk](http://cleardecorators.co.uk)

## **NICK MAHONY**

Qualified Gardener & Plantsman - Specialist Pruning

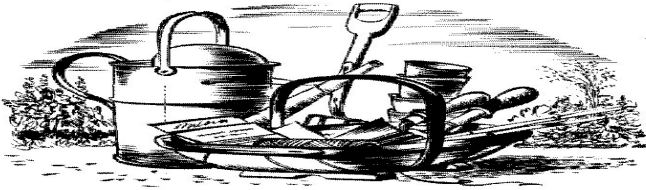

Telephone: 01364 631194. E-mail: [nickplantsperson@btinternet.com](mailto:nickplantsperson@btinternet.com)



Licensed User

  
**dartforest**  
tree works



Tree Surgeons

- All Aspects of Tree Surgery
- Tree Decay Testing

Aran Kimberlee  
BSc (Hons) Arboriculture, M Arbor A  
[aran@darforesttrees.co.uk](mailto:aran@darforesttrees.co.uk)

- Tree Inspections & Reports
- Fully Insured

Tel: 01364 72804

- Stump Grinding
- Free Advice and Quotations

Mob: 07594 680168

[www.dartforesttrees.co.uk](http://www.dartforesttrees.co.uk)

**HOUSE, PET &  
LIVESTOCK SITTING  
ON DARTMOOR**

**Jean Avery**

3, Langworthy Brook,  
Halshanger, Ashburton,  
Newton Abbot. TQ13 7JA.

**07561259307**

[Jeanavery2010@hotmail.co.uk](mailto:Jeanavery2010@hotmail.co.uk)



## Postbridge Whist Drives - Held in the Village Hall

**All Whist Drives are cancelled until further notice.**



Learners are especially welcome. Entrance fee of £2.50 to include refreshments and prizes.

Contact: Jackie Gee, Bungalow 2, Dartfordleigh, Postbridge, Yelverton, PL20 6TJ.

Tel: 01822 880224

## High Moorland Women's Institute Princetown

If you would like to be a part of a hugely respected organisation, come along to one of our monthly meetings for a taster to see if WI is for you. We meet on the **first Wednesday of each month at 7.30pm in the Community Centre small hall Princetown**. It will cost you £3. You are welcome to attend two meetings as a taster. We are a fun group of mixed age range ladies and we do have a good laugh. Do come and see what we get up to.



**All meetings are cancelled until further notice**

If you would like to know more about High Moorland Women's Institute or details of the events listed above, please drop Helly an email on [hellyhtsn@hotmail.com](mailto:hellyhtsn@hotmail.com) or follow us on Facebook: High Moorland Women's Institute.



## Postbridge Coffee Mornings

Once again we have had to change the date of our first meeting.



Lets hope we can meet on **Monday 2 August at Postbridge Village Hall.**

We will keep you updated.

Looking forward to seeing you all.

*Maureen & Sheila*

## Princetown History Club

July 6th - A walk around Moretonhampstead, with Gary Cox

August 3rd - A visit to Whiteworks, with Andy Crabb, DNPA archeologist.

For further information, please phone Mr John Lissenden on 01752 847573

or email: [jlissenden@talktalk.net](mailto:jlissenden@talktalk.net) Web Site: [princetownhistoryclub.weebly.com](http://princetownhistoryclub.weebly.com)

# Church Services for July 2021

## 4th July Trinity 5 Green

*Readings - Ezekiel 2:1-5; Psalm 123; 2 Corinthians 12:2-10; Mark 6:1-13*

Widcombe	10:30	Pet Service	Ashburton	08:00	Holy Communion
Leusdon	16:00	Pet Service	Bickington	09:00	Holy Communion

## 11th July Trinity 6 Green

*Readings - Amos 7:7-15; Psalm 85:8-13; Ephesians 1:3-14; Mark 6:14-29*

Postbridge	09:00	Holy Communion	Ashburton	09:00	Sundays@9am
Widcombe	10:30	Parish Communion	Ashburton	10:30	Parish Communion
Leusdon	12:00	Parish Communion			
Holne	18:00	Holy Communion			

## 18th July Trinity 7 Green

*Readings - Jeremiah 23:1-6; Psalm 23; Ephesians 2:11-22; Mark 6:30-34, 53-56*

Huccaby	09:00	Holy Communion	Ashburton	09:00	Sundays@9am
Widcombe	10:30	Parish Communion	Ashburton	10:30	Parish Communion
Leusdon	12:00	Parish Communion			

## 25th July Trinity 8 Green

*Readings - 2 Kings 4:42-44; Psalm 145:10-19; Ephesians 3:14-21; John 6:1-21*

Widcombe	10:30	Parish Communion	Ashburton	09:00	Breakfast Church
Leusdon	12:00	Parish Communion	Ashburton	10:30	Time & Talents
Holne	17:00	Evening Worship			Communion
Postbridge	18:00	Evening Prayer	Buckland	18:00	Community Songs of Praise

## 1st August Trinity 9 Green

*Readings - Exodus 16:2-4, 9-15; Psalm 78:23-29; Ephesians 4:1-16; John 6:24-35*

Widcombe	10:30	All Age Service			
Leusdon	16:00	Evensong			

**These are the services planned for July, subject to any changes in Covid rules.**

### **Should I wear a face covering in a church building?**

Face coverings are currently mandatory in places of worship. While there are exemptions **this is a legal requirement.**



There is a service of  
**Holy Communion**  
**every Wednesday**  
**at 10.30**  
 at St. Andrew's Church  
 in Ashburton  
 You will be most welcome!.



## Communion at home

If you would like to receive Home  
 Communion please contact Mark or  
 Geoffrey.

*(see page 2 for contact details)*

### Mid-week Communion

Wednesday 7th July	Ashburton	10:30	
Wednesday 14th July	Ashburton	10:30	
Wednesday 21st July	Ashburton	10:30	
Wednesday 28th July	Ashburton	10:30	
Wednesday 4th August	Ashburton	10:30	

### Key to Service Leaders

MR	Revd Mark Rylands	SS	Steve Sheldon	JA	Revd John Andrews
AR	Revd Mandy Rylands	DW	Revd David Witchell	HL	Heidi Lewis
GF	Revd Geoffrey Fenton	SLW	Simon Le-Pine Williams	KH	Revd Kevin Hooke
JG	Revd John Good	WW	William West	JAsh	Jane Ashton
AK	Anthony Kyriakides	CA	Chloe Axford		

### Dates for the Diary

July 2021		Page
6th	Princetown History Club	23
10th	Messy Church	9
August 2021		Page
2nd	Postbridge Coffee Morning	23
3rd	Princetown History Club	23
4th	Leusdon Hall AGM	17

August 2021		Page
14th	Leusdon Dog Show	19
September 2021		Page
1st	Leusdon Coffee Morning	19
11th	Widecombe Produce Show	28
11th	Parish Field Open Day	32



## **THE RUGGLESTONE INN**

WIDECOMBE IN THE MOOR

Home from home with Cask ales, fine wines, local cider & country food.  
Traditional Dartmoor Inn with an inviting atmosphere, all set in  
a fabulous beer garden, with moorland brook.

### ACCOMMODATION

Rugglestone Cottage set in the grounds of the inn offers two bedrooms,  
open plan kitchen / living area and private patio.

Available all year round.

[www.rugglestoneinn.co.uk](http://www.rugglestoneinn.co.uk)

01364 621327



Our man on the Moor,  
Richard Copus has  
over 30 years  
unrivalled experience  
of Dartmoor  
Properties



## **ROBERT WILLIAMS**

*Estate Agents & Auctioneers*

***selling and auctioning homes on Dartmoor for  
a third of a century and providing valuation  
advice for probate, matrimonial and other  
professional purposes***

RICHARD COPUS FNAVA FNAEA (Honoured) CPEA

Tel: 07766 335344

E-mail: [richard@robertwilliams.co.uk](mailto:richard@robertwilliams.co.uk)

Web site: [www.robertwilliams.co.uk](http://www.robertwilliams.co.uk)

**COVERING THE WHOLE OF DEVON FROM THE HEART OF DEVON'S  
COUNTY TOWN, 2 SOUTHERNHAY WEST, EXETER, EX1 1JG**

with 70 associated offices in the south-west and a London connection



# St Pancras, Widecombe-in-the-Moor

For contact information, ministers and church officers see front of the Link

**Church Services - see Page 24 for details**

Date	Time	Service
4th July	10:30	Pet Service
11th July	10:30	Parish Communion
18th July	10:30	Parish Communion
25th July	10:30	Parish Communion

## Widecombe Church - Information and Support

Widecombe Church is now open every day from 9am to 5pm. You are welcome to visit during these hours – an opportunity to light a candle, say a prayer, buy a guidebook, postcard or small gift, or just enjoy our beautiful building.

*Please wear a face-covering when inside the church, and be sure to use the hand-sanitiser when you enter and when you leave.*

We are holding services in the church every Sunday. If you are not able to attend, why not download the latest service and use it at home? You can find it here:

<https://www.moorlandteam.org.uk/w>

Do give me a call if you'd like a chat.

Revd Geoffrey Fenton (Team Vicar) 01364 621334 [geoffrey@moorlandteam.org.uk](mailto:geoffrey@moorlandteam.org.uk)

## Three-bedroom house for affordable rent in Widecombe

This summer, Widecombe-in-the-Moor Church House and Lands Charity is expecting to have a three-bedroom house for affordable rent at Church Cottages, Dunstone.

At this stage, the charity is seeking expressions of interest from anyone who might be interested in applying for a tenancy at that time.

If you are interested, please email the charity's clerk ([david.thomas@hotmail.co.uk](mailto:david.thomas@hotmail.co.uk)) with your full name, address and contact details - indicating briefly why you need a house (1) with three bedrooms (2) at an affordable rent (3) in Widecombe.

Widecombe



**SATURDAY 11TH SEPTEMBER 2021 IN THE CHURCH HOUSE WIDECOMBE and VILLAGE GREEN**

**SUBJECT TO COVID RULES AT THE TIME.**

Entries will be limited to Widecombe and adjoining Moorland parishes only.

Craft & Produce - Entry fee £2 per person will cover multiple entries, only one entry per class

## PRODUCE AND CRAFT SCHEDULE

<p><b><u>Vegetables Classes</u></b></p> <ol style="list-style-type: none"> <li>1. 3 potatoes washed, white</li> <li>2. 3 potatoes washed, red</li> <li>3. 3 onions grown from sets</li> <li>4. 3 carrots trimmed and washed</li> <li>5. 3 beetroot trimmed and washed</li> <li>6. 6 runner beans</li> <li>7. Any vegetable not in schedule</li> <li>8. Any squash or courgette</li> <li>9. 4 tomatoes</li> <li>10. 4 culinary herbs in a jar</li> <li>11. Comedy vegetable....!</li> </ol>	<p><b><u>Flowers</u></b></p> <ol style="list-style-type: none"> <li>1. 3 dahlias</li> <li>2. Single Rose</li> <li>3. Single stem any flower</li> <li>4. A vase of mixed flowers (9 stems – 3 of each)</li> <li>5. An arrangement of flowers and foliage in an unusual container.</li> <li>6. Miniature flower arrangement not to exceed 6"</li> <li>7. A standard flower arrangement</li> </ol> <p><b>Note: ALL FLOWERS MUST BE LOCALLY GROWN</b></p>
<p><b><u>Home Produce</u></b></p> <ol style="list-style-type: none"> <li>1. Victoria sponge</li> <li>2. 4 Tea cakes</li> <li>3. Savoury flan</li> <li>4. A plate of nine biscuits ( 3 of each)</li> <li>5. Battenberg cake</li> <li>6. Traditional meat pasty</li> <li>7. Rustic loaf</li> <li>8. A pot of jam</li> <li>9. A jar of chutney</li> <li>10. A bottle of homemade drink</li> </ol>	<p><b><u>Art and Craft</u></b></p> <ol style="list-style-type: none"> <li>1. Patchwork or quilting item</li> <li>2. A knitted item</li> <li>3. A painting (any subject, any medium)</li> <li>4. Pebble Art</li> <li>5. Any craft work not in schedule</li> <li>6. Made from Wood</li> <li>7. A short poem</li> <li>8. A photograph (My Dartmoor Garden)</li> </ol>
<p>ENTRIES TO be submitted by <b>Wednesday 8<sup>th</sup> September</b> to MIKE &amp; JENNY PASCOE 621333  <a href="mailto:pascoewooder@yahoo.co.uk">pascoewooder@yahoo.co.uk</a></p> <p><b>EXHIBITS TO BE STAGED ON THE MORNING BETWEEN 10am AND 12.30pm,  Public Viewing 2pm to 5pm. Entries to be removed between 5pm and 6pm.</b></p>	
<p style="text-align: center;"><b>FAMILY FUN DOG SHOW</b></p> <p style="text-align: center;">On the Village Green, entries on the day only, from 2.30pm - £1 per person.</p>	
<p style="text-align: center;"><b>FUN RUN Around the Village</b></p> <p style="text-align: center;">Starting on the Village green at 4PM</p>	

## WIDECOMBE FAIR



## WIDECOMBE FAIR COMMITTEE COMPANY LIMITED

We are looking for a volunteer with some business experience to take over the role of Company Secretary.

Please contact the Chairman, Mike Pascoe on 01364 621333

### Widecombe Church House Management Committee Chairman - Mike Pascoe

To book the Hall please contact Rose Mortimore 01364 631238.

#### Rates of Hire (Local Events)

Daytime £3.50 per hour

Evenings £5.00 per hour

All Day £20.00

These rates are for local non commercial events only. For other rates please ask the bookings secretary.

Payment by cheque is preferred. Cheques to be made payable to Widecombe Church House Fund and sent to Sarah Reeve, Bonehill Cottage, Bonehill Lane, Widecombe-in-the-Moor, TQ13 7TD

*For all other matters relating to the Church House please contact Diana Cameron on 01364 621218*

**All Widecombe & District History Group meetings are cancelled until further notice.**

Contact: Helen Barrow - [helenagsec@gmail.com](mailto:helenagsec@gmail.com) or  
Rosemary Mortimore - 01364 631238

**Mr Cleanpair**



Homes, Offices  
& Commercial Premises

Cleaning & Maintenance

Carpets & Upholstery

Builders Cleans

Holiday Homes &  
Rented Properties

Laundry Service Available

Trustworthy and reliable

Exceptional Quality &  
Meticulous Attention to Detail

CSCS approved & fully insured

Lora K Fielding

t. **01364 621 646**  
m. **07966 261 765**

[www.acleanpair.co.uk](http://www.acleanpair.co.uk)  
[acleanpair@btinternet.com](mailto:acleanpair@btinternet.com)

# M. STORRS

## RURAL SERVICES

FENCING- STOCK / POST & RAIL / WOODEN

TREE WORK & WOODLANDS

DRY STONE WALL & STONE HEDGE REPAIRS

HEDGE TRIMMING / LAYING / PLANTING

BRUSH CUTTING & SCRUB CLEARANCE

**NPTC & City and Guilds qualified**  
**Fully insured**

**Free quotes and advice**

Tel 07508 043 703  
01822 890 509

[www.storrs-landscapes.co.uk](http://www.storrs-landscapes.co.uk)

COVERING DARTMOOR AND SURROUNDING AREAS

## CHIMNEY SWEEP



- QUALIFIED SWEEP (City & Guilds, HETAS)
- Member of APCIS
- Experienced
- Very Clean

**CALL Steve Thompson on:**

**07866 025686 or 01626 587587**

email: [steve@thechimney-sweep.co.uk](mailto:steve@thechimney-sweep.co.uk)  
[www.thechimney-sweep.co.uk](http://www.thechimney-sweep.co.uk)



# CHRISTOPHERS' FAMILY FUNERALS

INDEPENDENT FUNERAL DIRECTORS

**01364 654065**

Bridge House, 9 Kingsbridge Lane, Ashburton, TQ13 7DX  
[www.christophersfunerals.co.uk](http://www.christophersfunerals.co.uk)      [info@christophersfunerals.co.uk](mailto:info@christophersfunerals.co.uk)



## Widecombe & District Sports Group

**Membership renewals are now due** if you have not received yours please email [cl.partridge@hotmail.co.uk](mailto:cl.partridge@hotmail.co.uk) or tel: 621468.

Alternatively membership forms can be found in the noticeboard by the court.



**Regular Bookings: Tuesday & Thursday:** Tennis Adults (16+) 6.30 Under 16's with ability are welcome to these sessions with a parent who is also playing.

For queries re tennis phone Di Cameron on 621218.

Please remember to wear soft soled shoes and to leave the court tidy with the net replaced. Report any damage immediately to Claire Partridge (Secretary) on 621468. Close all gates and replace the keys.

For more information about WDSG visit [www.widecombe-in-the-moor.com/sports\\_group/](http://www.widecombe-in-the-moor.com/sports_group/)

Thank you and enjoy your sports area.

## Widecombe Pre-School

At Widecombe Church House, established since the 1970's, our OFSTED inspected and highly rated sessions are designed to prepare your child for an easy and happy introduction to school. Through qualified and trained staff, we provide a safe and stimulating environment.

Tues 9.15am - 3pm Weds 9.15 - 12.45pm Fri 9.15am - 3pm

Tel: 01364 621273

**All Widecombe & District Ladies Social Group meetings are cancelled until further notice.**

For more details phone Rose 631238

## WIDDYTOTS

Widdytots is a local group of mums with babies and toddlers from 0-3 years.

We are in the process of working out the logistics of restarting the toddler group sessions but in the meantime if you would like to be put in contact with other local mums and to catch up for a walk or a coffee and a chat etc then please do contact us.

For more information please call the preschool on **01364 621 273**



***Open Day on the Parish Field, Widecombe  
Organised by the Parish Council***

**POSTPONED UNTIL SEPTEMBER 11TH**

***Have you ever seen the Parish Field in Widecombe?  
Do you know where it is? Have you even heard of it?  
You are invited to spend an afternoon enjoying it .....***

***Bring your own Picnic and enjoy being Covid safe  
in the sun! (Small print - sadly sun not guaranteed.)  
Licenced Bar selling cider and soft drinks...***

***Entertainment from 2.00:***

*Widecombe School Maypole Dancing  
Widecombe Hand-bells demonstration raising funds for their refurbishment  
History Group display about the field and its leat  
Displays about the plant communities in the ancient meadow  
Dartmoor National Park "Time for Nature" Challenge  
Pre-school activities and children's races  
Apple juicing as a foretaste of the future planned Orchard tree-planting*

***We'd also like you to tell us how best to use the field  
in the future....***

***Community Apple Orchard? Allotments? Picnic site?  
History and information boards?***

***It's your field and we want to make it a wonderful asset  
for the Village!***

*Please contact Daf Edwards (01364 621242)  
or Geoffrey Fenton (01364 621334)  
if you'd like to run an activity or have a display.*



## British Normandy Memorial

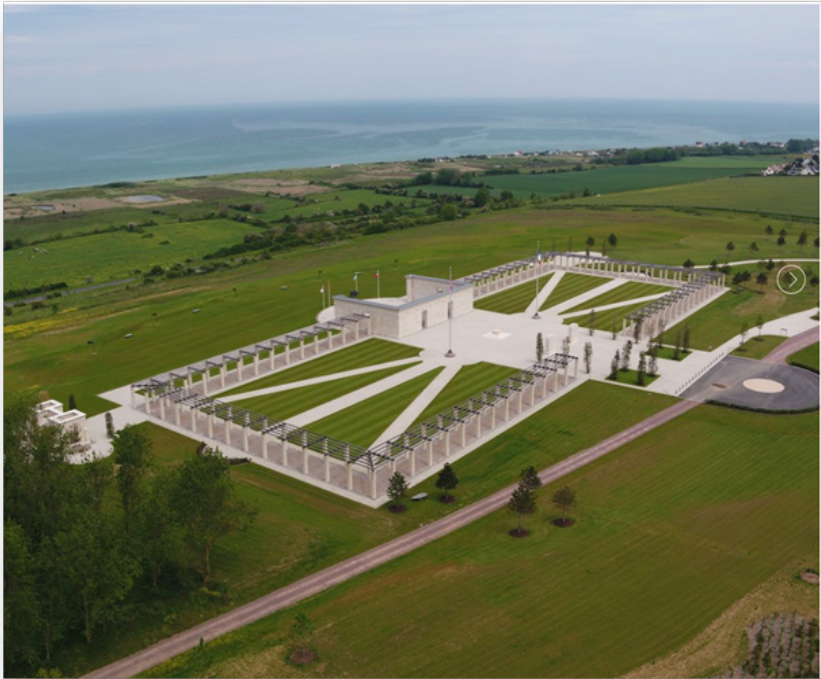

Many of you will have seen on television or read in the newspapers of the opening of the British Normandy Memorial at Ver-sur-Mer in Normandy on 6th June, (the 77th Anniversary of the D Day landings in World War 2).

The memorial, which is located on a hillside overlooking 'Gold Beach' where the landings were undertaken by British and Commonwealth forces, contains the names of the 22,442 servicemen killed in the 3 months of fighting following the landings.

Included on the memorial is the name of **EDWARD WHITLEY** formerly of Spitchwick Manor in Widecombe Parish.

*Continued on page 34*

*(Continued from page 33)*



Edward was wounded during the landings at Pegasus Bridge, part of the D Day offensive, on 10th August 1944.

He died of his wounds in hospital in England on 29th August. His name is included on column 332 of the memorial.

Edward, a Captain in the Royal Army Medical Corp, had parachuted into the war zone as part of the 13th (2/4 Battalion South Lancashire Regiment).

His Service Number was 22025

*David Ashman, Widecombe History Group*

## **The involvement of the CLEVE family from Widecombe in the American Civil War**

As mentioned in my article in the June edition of the "Parish Link" a number of families who emigrated from Widecombe during the 1850's became involved in the American Civil War after they arrived in their new homes.

James Cleve and Mary his wife (nee Ireland) emigrated from Cresson Hays, Leusdon in 1850 along with the first four of their children, six further children were born to the couple in America.

The involvement in the Civil War relates to the eldest three girls all of whom married American men who were "called" to fight for the Unionist cause.

Eldest daughter Dora Cleve married Lucius Daniel Whaley in 1863. Lucius was born in 1836 and enlisted in the 103rd Ohio infantry in August 1862. He was wounded early in 1863 and 'mustered out' in early January. Lucius and Dora did not marry until July 1863 after Lucius had left the army. Like her mother Dora, she had a large

*Continued on page 35*

*(Continued from page 34)*

family with nine children.

In 1872 second daughter Nelly married Albert Glassford who had served throughout the war with the 78th Infantry Regiment of Ohio. In contrast to family tradition Nelly only had two children.

The youngest of the immigrant daughters Mary Grace married Augustus Farlin House.



***Mary Grace House (nee Cleve)***



***Augustus Farlin House***

Augustus served as a private in the Ohio cavalry. Mary and Augustus had only three children.

Further stories of the 'Men from Widecombe who fought during the American Civil War' will be told in the coming months.

*David Ashman, Widecombe History Group*

# Widecombe General Store

**Now Open**

in

**Widecombe in the moor**

**Get all your essentials from our general store**

**Fruit and veg**

**Bread and milk**

**Jams & chutneys**

**Flours, pasta & rice**

**&**

**Toiletries**

**Also a range of Organic Wholefoods**

**And so much more**

**Everything you need for your daily or weekly shop.**

**Beers, wines, ciders & spirits**

**Local Produce**

Email

widecombegeneralstore  
@outlook.com



Sextons Cottage  
Widecombe in the  
Moor

TQ13 7TA

07517194517

Proprietors

John & Jenny  
Parnham

**NEWTON ABBOT - BOVEY TRACEY Via Heathfield - Stagecoach 39**  
**BOVEY TRACEY - WIDECOMBE Via Haytor - Stagecoach 271**

**Saturday (Except Public Holidays) - 29th May - 30th October 2021**

**Monday - Friday (Except Public Holidays) 26th July - 3rd September 2021**

	39	39	39	39	39	39
<b>NEWTON ABBOT, Sherborne Road B</b>	<b>0920</b>	<b>1020</b>	<b>1120</b>	<b>1320</b>	<b>1420</b>	<b>1520</b>
DRUMBRIDGES, Roundabout	0930	1030	1130	1330	1430	1530
HEATHFIELD, Battle Road	0933	1033	1133	1333	1433	1533
BOVEY TRACEY, Riverside Surgery	0943	1043	1143	1343	1443	1543
BOVEY TRACEY, Union Square, Tesco Arrive	0949	1049	1149	1349	1449	1549
<i>Continues as service 271 to Widecombe</i>	271	271	271	271	271	271
<b>BOVEY TRACEY, Union Square, Tesco Depart</b>	<b>0952</b>	<b>1052</b>	<b>1152</b>	<b>1352</b>	<b>1452</b>	<b>1552</b>
HAYTOR VALE, Moorlands House	1002	1102	1202	1402	1502	1602
<b>WIDECOMBE, Car Park</b>	<b>1013</b>	<b>1113</b>	<b>1213</b>	<b>1413</b>	<b>1513</b>	<b>1613</b>

	271	271	271	271	271	271
<b>WIDECOMBE, Car Park</b>	<b>1018</b>	<b>1118</b>	<b>1318</b>	<b>1418</b>	<b>1518</b>	<b>1648</b>
HAYTOR VALE, Moorlands House	1030	1130	1330	1430	1530	1700
BOVEY TRACEY, Union Square, Tesco Arrive	1045	1145	1345	1445	1545	1715
<i>Continues as service 39 to Newton Abbot</i>	39	39	39	39	39	39
<b>BOVEY TRACEY, Union Square, Tesco Depart</b>	<b>1049</b>	<b>1149</b>	<b>1349</b>	<b>1449</b>	<b>1549</b>	<b>1719</b>
HEATHFIELD, Battle Road	1059	1159	1359	1459	1559	1729
DRUMBRIDGES, Roundabout	1102	1202	1402	1502	1602	1732
<b>NEWTON ABBOT, Sherborne Road</b>	<b>1112</b>	<b>1212</b>	<b>1412</b>	<b>1512</b>	<b>1612</b>	<b>1742</b>

Visit [http://www.devonbustimetables.info/teignbridge\\_new](http://www.devonbustimetables.info/teignbridge_new) for the full service 39 and all other Teignbridge bus timetables



# P & S

**AUTO'S**

**THE BARN WORKSHOP**

POTTERY ROAD BOVEY TRACEY TQ13 9DS

TEL: 01626 437747 Email: [pandsautos2019@gmail.com](mailto:pandsautos2019@gmail.com)

## SERVICING & REPAIRS

**All Make & Models Welcome**

Over 38 years' experience and a member of the IMI

Full Servicing With O: E Parts

All Types of Repairs IE:  
Brakes, Electrical, Exhaust,  
Welding, Clutches  
M.O.T Pre-checks & Arranged

Please call for a quote and ask for Paul

For a 10% discount please quote Ref: LINK0619

Wells • boreholes • control systems  
pumps • filtration • servicing • breakdowns

## Aqua Tech Water Services

Private Water Engineers

[www.aquatechwaterservices.co.uk](http://www.aquatechwaterservices.co.uk)



**Tel: 01409 241312**

**Mob: 07825 748720**

Email: [aquatechwaterservices@googlemail.com](mailto:aquatechwaterservices@googlemail.com)

## PILATES ONLINE

**Be Part of a Group Staying Fit & Active in Lockdown!**

These classes are suitable for varied ages and abilities. Beginner to improver level. Join a small, friendly group, where you are clearly visible to the teacher whilst you exercise in the comfort of your home. Instructor can offer you all the technical support you may need to join an online class.



**Monday Evenings**

6 – 7.15pm & 7.30 – 8.45pm

**Tuesday Mornings**

9.15 – 10.30am & 10.45 – noon

**Thursday Mornings**

9.15 – 10.30am

10.45 – 11.45am (over 60's group)

**Further Information:** Faith Burch

07952 157585 [faithburch1964@gmail.com](mailto:faithburch1964@gmail.com)

Qualified with The Pilates Foundation

## Mike Gilbert Architectural Design.

Design & drawings for Planning /  
Building Regulation approval  
Extensions, alterations &  
new buildings.

Residential and commercial.

Established 20 years.

Free Initial consultation

**Tel 01364 631031**

Email: [designdrawings@btinternet.com](mailto:designdrawings@btinternet.com)

Website: [www.plans2build.net](http://www.plans2build.net)





## Dunstone & Poundsgate Methodist Chapels

Ministers: Rev'd Kevin Hooke (01626) 832369

Church contacts: Nigel Davis (01364) 631476 or Serena Walcot (01364) 631279

### Sunday Service

**Dunstone** - Every Sunday 3pm informal service held outside the chapel so we can sing or inside if wet but no singing. Everyone most welcome but must follow the two metre distance rule and masks must be worn when we are inside.

**Poundsgate** - First Sunday of the month only, 3pm Zoom

For login and phone in details please contact Serena Walcot on **01364 631279**.

### Bible Study Group

We continue to meet via Zoom every Thursday evening at 6pm. We are studying the Acts of the Apostles at the moment and everyone is very welcome to join us. We are a small friendly group seeking to enrich our knowledge of God through His word in the Bible.

Please phone Serena Walcot on **01364 631279** for Zoom login or phone in details.

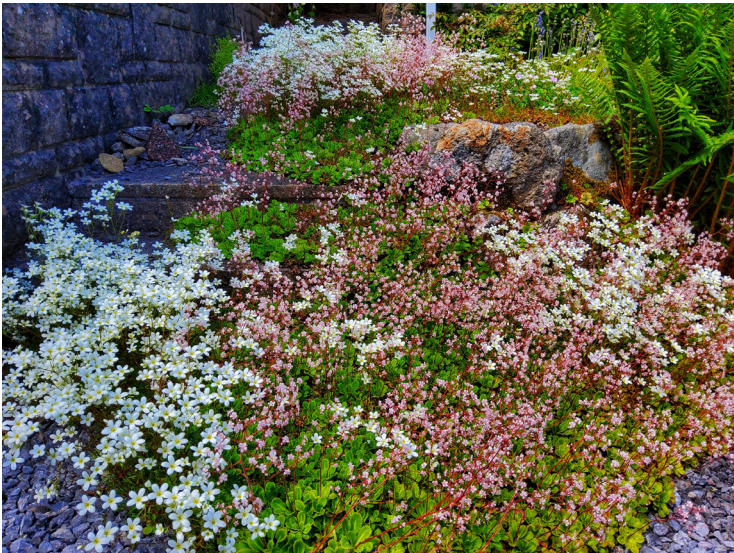



# Francis Parffrey Legal Services Ltd

## CONVEYANCING - POWERS OF ATTORNEY - PROBATE SERVICES - WILLS

We can help you here in the Ashburton and Moorland Area

Free initial home visit

Please contact Francis by phone at

**01364 653 331 or 07443 622 903**

### Digger and Dumper Hire

#### Self Drive or Operated



- 1.5 Tonne Mini Digger c/w expanding tracks (1 Meter Overall Width) Quick Hitch, Range of Buckets
- 3 Tonne Diggers with Quick Hitch also Concrete Breaker and Post Hole Borer
- 3 Tonne Dumpers, Straight Tip and Swivel Tip

Also available Bobcat Skid Steer Loader, Plate Compactor and Cement Mixer

**Please Contact Bryan Booty on:**

**Home: 01364 631 346**

**Mobile: 07968 320131**

[bryan@roguesroost.co.uk](mailto:bryan@roguesroost.co.uk)

[www.roguesroost.co.uk](http://www.roguesroost.co.uk)



REGISTERED  
MEMBER

### Emotional health and clear thinking

Whatever the cause, you *don't* have to suffer from stress and anxiety: panic attacks: depression: phobias: trauma: low "self-esteem": anger: poor sleep

#### ***Make a difference today***

Proven talking therapy techniques combined with the most up-to-date psychological knowledge help you to move on as quickly as possible.

**To learn more call Carol Harper**

01364 631044

[www.hgi.org.uk](http://www.hgi.org.uk) and [www.carol-harper.co.uk](http://www.carol-harper.co.uk)

*Carol is a fully qualified Human Givens practitioner, and a member of the British Complementary Medical Association*



### News from the East Shallowford Trust

Has anyone seen that dystopian movie from 1966 with Julie Christie - Fahrenheit 451? They made a remake in 2018 – but I have not seen it yet. Anyway, it's based on a Ray Bradbury book, where paper books burn at 451 degrees instigated by 'fire-men' whose role is *not* to put fires out, but burn literature in order to destroy knowledge.

The irony for us was that it's taken me two days to try and find someone to conduct a new and revised Fire Risk Assessment combining the new Barn with an updated version of previous plans for the house. This combined with the fact that we have twelve visitors who are undertaking training in our yard, wandering around with open folders, memorising scripts, holding the folders as they walk carefully in purposeful circles, jolted my head back to memories of the movie seen when I was young. It really does look like something out of the 1966 movie.....



**Duck herding: an amusing communication challenge.....**

Which brought me back to another thought..... memory making and how it shapes our decisions and behaviour. The assumption that we can make 'good' memories that can positively affect ones' entire life, is, of course, the whole reason Miss Braund and Rosemary started on the East Shallowford adventure. Yet current research states this battle for positivity could possibly be harder than we thought.

A growing body of literature supports the "foetal origins hypothesis" where 'prenatal environmental exposures — including maternal psychological state-based alterations in *in utero* physiology — can have sustained effects across the lifespan.' The theories were first

*Continued on page 42*

(Continued from page 41)

developed in research following the Dutch Hunger Winter of 1944 based on offspring of women who were pregnant at the time when food intake was reduced to 500 – 1500 kcal per day during WWII. In a series of studies, Brown and colleagues illustrated that foetal development during this period was associated with a two-fold increased risk of schizophrenia, schizoid/schizotypal personality disorder, as well as comparable risk for major affective disorders in adulthood. Some of the issues of course resulted from many micro and macro nutrient deficiencies. However, other stressors (i.e. bereavement, daily hassles, and earthquakes), have been related to significant alterations in children's neurodevelopment, including increased risk for mixed handedness, autism, affective disorders, and reduced cognitive ability, ADHD etc. In short, women's mood-based physiology is thought to affect foetal neurobehavioral development. Scary..... women are perhaps even under more pressure and stress to have a 'perfect life'. We know smoking damages foetal development, but as a Mum, all you can do is your best and now research suggests you *have* to feel happy to produce balanced hormones or your child could develop 'fight or flight' responses instead of 'think and resolve' solutions??



***Challenges come in huge ranges. One of these ladies is a vegetarian, but still willing to help us package sausages. £6.00 for ten if anyone would like some. The Gloucester Old Spot, called 'Black-Spot' was prepared by Gages Farm last week. Seriously local!***

So, what chance do we have of repairing the damage? I asked this question to a bunch of women who visited the farm a couple of weeks ago. Some of them had come as children at the age of twelve and repeatedly for many years as they grew up. One cheerfully said, 'That would explain my son. He's got ADHD and I was really, really stressed when he was born and for a few years after. Until I got rid of his Dad who was a real pain.' Another one noted, 'Yep, makes sense. My son has dyslexia and can't sit down for very long. I had a horrible pregnancy, all sorts of stress and I was smoking.' Trying to understand, see the pitfalls and then help their own children to not repeat the same mistakes

Continued on page 43

(Continued from page 42)

Yet, at long last, recognition has been given to those who are different and do struggle. Those struggles can develop into skills that serve society and hopefully the individual. Alan Turing will be the face of the new GBP50 note. His brilliance surely was the result of his struggle with life. Do we not need challenges to develop, to be different, to be special, to see opportunities where others only run and hide? Robin Sharma stated that 'obstacles are the cost of greatness'. Like the eggs that hatched a few weeks ago. We had six duck eggs. Four hatched, two were fully grown but never made it out of the shell. Why? We do not know..... But they lacked that final strength. The amazing duckling is the one that we found one morning having wriggled out of it's pen to be found running around amongst the adult



***Singing at Dunstone Chapel:  
Ladies who once visited  
Shallowford as young girls now  
send their own children. Did we  
help? Certainly their stories are  
hilarious!***



chickens. One of them must have pecked it and broken the front of it's beak. The very tip of it's top beak has now fallen off and he has an ungainly strange look as you can see his tongue flickering speedily in and out. However, he does not give up. He can still gobble his crumb, slurp up water and runs at speed to meet his siblings. We were not sure..... would he overcome his adversity? Sure he does, with speed, amusement and great grace!

Some of our visitors have HUGE adversities and challenges to overcome. Some of the causes may have been in-utero, some genetic, some imposed by the families in which they

*Continued on page 45*

## ASHBURTON AND BUCKFASTLEIGH HOSPITAL LEAGUE OF FRIENDS

REG. CHARITY NO. 900416

Are you interested in helping your local  
community?

If so why not come and join your local League  
of Friends.

Our object is to relieve patients, former  
patients and those in our community who are  
convalescent, disabled, handicapped or infirm  
and generally to support the work of our local  
hospital.

For further information please contact our Sec-  
retary on: Tel. 01364 654079  
or email [essay.trawets@virgin.net](mailto:essay.trawets@virgin.net)

## DASH

District of Ashburton  
Surgery Help Line

## NEIGHBOURS HELPING NEIGHBOURS

DASH is an independent charity serving patients of  
Ashburton Surgery. We:

- Take you to any kind of medical appointment, and  
other trips
- Do your shopping if you are unwell
- Collect and deliver prescriptions
- Help with forms and letters

*Also, if you would like to help DASH as a volunteer,  
please call 01364 653335.*

# ST ANDREWS HOUSE



## Residential Care Home

*Traditional values  
for Tomorrow's world*

01364  
653053



West Street, Ashburton, Devon, TQ13 7DT  
[www.standrewsdevon.co.uk](http://www.standrewsdevon.co.uk)

Nourishment  
Value, Vitality  
Cleanliness  
Warmth  
Entertainment  
Security  
Privacy  
Comfort  
Companionship



(Continued from page 43)

grew up, some may be the result of mere accidents in life. We will not judge, most of the time we do not need to know. What is clear, is that adversity is necessary to pump the blood of life through us all. What to one person is a simple walking challenge up a hill, is to another an unbearably huge mountain. What we can provide is a new norm, a new sense of achievement and beauty in our little section of Dartmoor. What we can do, is not judge, but care and support and stretch. Aristotle's challenge: "Give me a child until he is seven and I will show you the man." Most of our visitors come from the age of eight, most from ten or eleven. We take on the challenge..... one person at a time

Julia

[www.shallowfordfarm.co.uk](http://www.shallowfordfarm.co.uk)



## Cleaners Wanted

We are looking for cleaners throughout July and August to help with a busy season.

Candidates must have transport (we are just outside Widecombe-in-the-Moor), be willing to work flexible hours and pay attention to detail.

Please contact Julia directly on:

Tel: 01364 621 392

E-mail: [julia@shallowfordfarm.co.uk](mailto:julia@shallowfordfarm.co.uk)

## Rainfall in May 2021

Place	Total Rainfall	Days without rain	Wettest Days
Postbridge	335.6 mm (13.2")	5	21st 40.8 mm
	(May 2020 - 12.3 mm (0.5"))		



## ***Contacting the Editorial Team***

Email items for inclusion or any other queries to: [link@moorlandteam.org.uk](mailto:link@moorlandteam.org.uk)

For items sent by post please use the following addresses:

Link Finances (donations, advertising fees, invoices etc)

All Other Correspondence

**Parish Link Treasurer**  
c/o Way Park  
Widcombe-in-the-Moor  
Newton Abbot  
Devon  
TQ13 7TU

**Parish Link**  
c/o The Vicarage  
Widcombe-in-the-Moor  
Newton Abbot  
Devon  
TQ13 7TF

Cheques payable to:

**P C C Widcombe - Link Account**

**Thank you to all those who make donations to the Parish Link.**

**Commercial advertising and donations ensure that the Link continues to be provided free of charge throughout the Moorland Team.**

**If you would like to make a donation, please contact the editorial team.**

## ***Groups and Individuals who support the Parish Link***

Dartmoor Forest Parish Council

Phyl's Follies (Postbridge)

Friends of Widcombe School

Postbridge Village Hall

High Moorland WI

Princetown History Society

Holne Fete Committee

Various anonymous donations

Holne Garden Group

Widcombe Church House Committee

Holne Parish Council

Widcombe Fair Committee

Holne Second-Hand Books

Widcombe History Group

Holne Village Hall Committee

Widcombe Ladies Social Group

Leusdon Memorial Hall

Widcombe Parish Council

Moorland Merry-makers

Widcombe Sports Group

We wait with bated breath for the end of Lockdown – maybe only a couple of weeks away? A big thank you to all our contributors who have kept The Link alive during these difficult times. We believe, and many readers have confirmed this, that The Link amply proves its worth month by month – chatty stories, adverts covering a host of trades and services, announcements for events and so on and so on.

So we are very proud of The Link! We believe it's a vital way of linking our moorland villages together. However, we badly need more people to help us keep The Link flourishing. Can you help? Roles include sourcing copy, finding and invoicing advertisers, designing layout and then distributing the finished product. Please consider if you can help us – just a few hours a month could make all the difference. Contact the editor on the email address below to let us know what you can offer. Thank you.

In this month's edition it's wonderful to see that there's a new daily bus timetable to Widecombe to be found on page 37! Starting from Newton Abbot, the bus magically changes from a 39 to a 271 at Bovey, though we guess it's actually the same bus – and to avoid the busloads of visitors coming up, local people can escape them by taking the returning bus and going to Bovey or Newton Abbot for shopping trips. Well done Stagecoach!

When you're not off to the shops in Newton, you need to be planting out and tending your vegs and flowers to get ready for the Widecombe Craft and Produce Show on 11th September (p28) – potatoes, onions, carrots, beetroot, beans – get them in now.... But it may be a little early to make those Tea cakes and pasties! And on the 11th there's also a Fun Run, a Dog Show and the Parish Field Open Day – a great day out.

If you've filled up your own garden, do put your surplus plants outside Holne Village Hall or at Hilltop to raise funds for the hall (p11). Alternatively, if you need plants, you now know where to find them.

So we hope you enjoy this edition – thank you for your support.

*From all of us at the Link*

### **Parish Link Advertising Costs**

<b>Size</b>	<b>Size</b>	<b>Month</b>	<b>Year</b>
<b>Sixth Page</b>	<b>61x60mm</b>	<b>£7.50</b>	<b>£80</b>
<b>Quarter Page</b>	<b>61x92mm</b>	<b>£12</b>	<b>£125</b>
<b>Half Page</b>	<b>128x92mm</b>	<b>£20</b>	<b>£215</b>

**Please contact the Editorial Team for information and availability of advertising space at [link@moorlandteam.org.uk](mailto:link@moorlandteam.org.uk)**

### **Final Copy Deadline**

*for the **August 2021** edition of the Link will be **Sunday 18th July** but please send as early as you can by email. Next issue available on **Thursday 29th July***

# CARROLL CLEANING SERVICES

*SINE FUCO ET FALLACIIS CONDOCIMUS*

*Established 1985*

**WINDOW CLEANING &  
SOLAR & PV PANELS,  
TENNIS COURTS & OUTDOOR SPORTS SURFACES.**



01626 897297

07771 761125

[info@carrollcleaning.co.uk](mailto:info@carrollcleaning.co.uk)

[www.carrollcleaning.co.uk](http://www.carrollcleaning.co.uk)



The Hollies, Avenue Road, Bovey Tracey TQ13 9BQ

Est

**RENDELLS**

1816

[www.rendells.co.uk](http://www.rendells.co.uk)

Chartered Surveyors - Estate Agents - Letting Agents - Land Agents - Commercial Agents -  
Livestock Specialists - Fine Art - Smallholders Markets - Farm & Machinery Sales -  
Valuers - Auctioneers



**Newton Abbot Office:**

13 Market Street, Newton Abbot, Devon, TQ12 2RL

Tel: 01626 353881 / Fax: 01626 365030

Email: [newtonabbot@rendells.co.uk](mailto:newtonabbot@rendells.co.uk)